

NATIVE TREES AND SHRUBS TO REMAIN. UNDERSCRUBBING TO OCCUR OUTSIDE OF ASSET PROTECTION ZONE TO CONTROL BUSHFIRE PRONE AREA

PLANTS ARE TO BE CLEARED WITHIN 30 METERS FROM THE PROPOSED DWELLING TO ESTABLISH A SATISFACTORY ASSET PROTECTION ZONE AND LANDSCAPED IN ACCORDANCE WITH SECTION 5 OF THE PLANNING FOR BUSHFIRE PROTECTION 2006

**BUSHLAND**

**DENISON RD**

20000

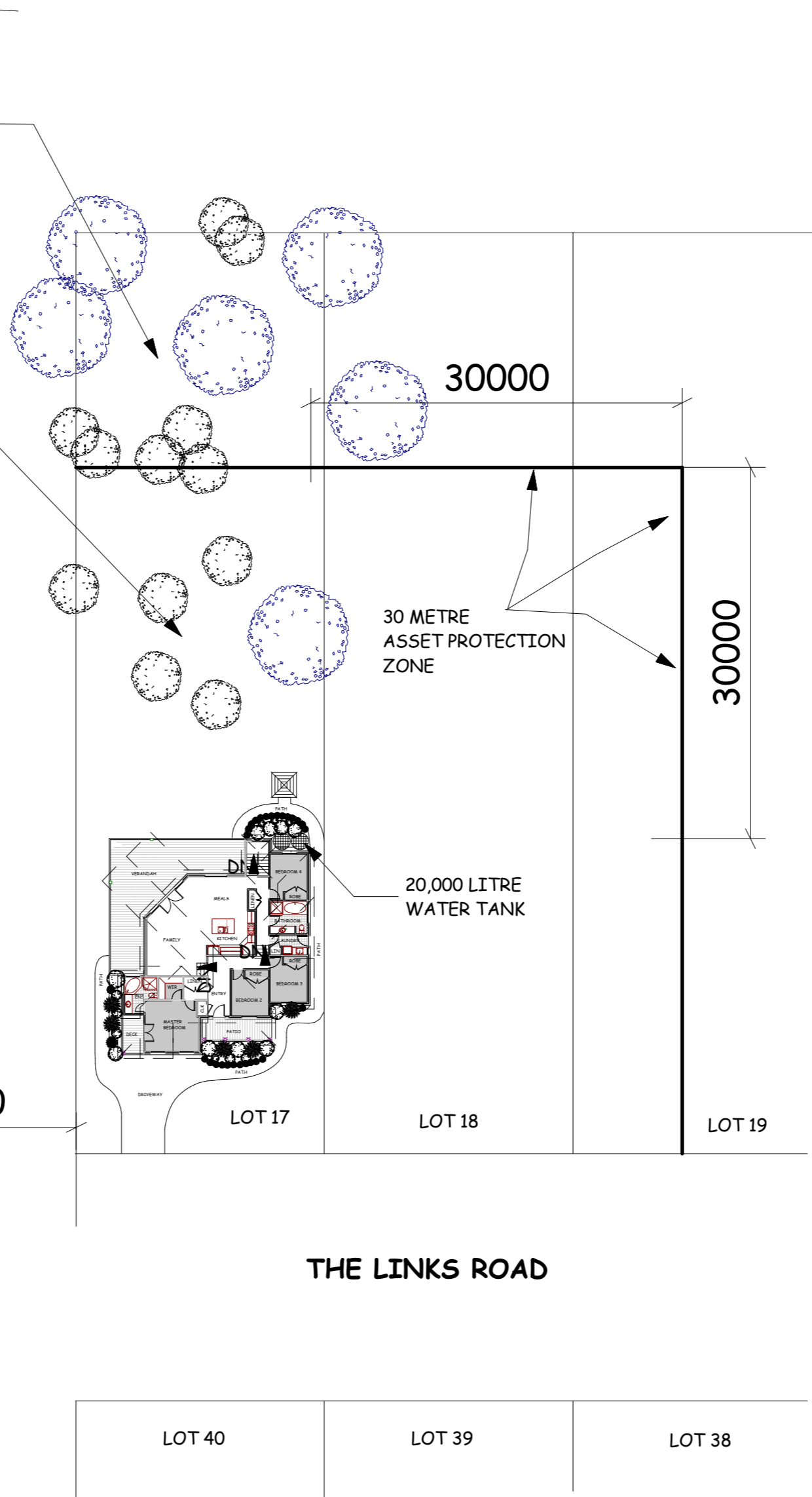

30 METRE ASSET PROTECTION ZONE

20,000 LITRE WATER TANK

**THE LINKS ROAD**

LOT 40

LOT 39

LOT 38

**NOTES:**

- NO FLAMMABLE PLANTS/SCRUBS ARE TO BE LOCATED WITHIN 10 METRES OF THE PROPOSED DWELLING
- THIS ASSET PROTECTION PROPOSAL FORM STAGE 2 OF THE OVERALL SUBDIVISION STRATEGY AS DETAILED IN THE DA FOR LOT 1 ( DOCUMENT ATTACHED)
- NO TREES TO BE OVERHANGING WITHIN 5 METRES THE PROPOSED DWELLING TO PREVENT THE ACCUMULATION OF LEAF LITTER WITHIN ROOF GUTTERS AND VALLEYS
- CONSTRUCTION IS TO COMPLY WITH AS3959 - 1999 LEVEL 3 " CONSTRUCTION OF BUILDINGS IN BUSHFIRE PRONE AREAS" WITH THE EXCEPTION THAT ENTIRELY NON COMBUSTABLE MATERIALS ARE UTILISED AND THAT NO EXPOSED TIMBER IS PERMITTED
- ALL GLAZING TOWARDS THE BUSHFIRE HAZRD ON THE NORTH, WEST AND SOUTH ASPECTS TO BE ENTIRELY ENCLOSED WITH NON COMBUSTABLE SHUTTERS ON ALL WINDOWS DIRECTLY EXPOSED TO THE BUSHFIRE HAZARD TO THE WESTER AND NORTHWEST ASPECTS. WINDOW SEALS TO HAVE A FLAMABLE INDEX IN ACCORDANCE WITH AS1530.2
- ALL DOORS FACING THE BUSHFIRE ON THE NORTH AND WEST ASPECTS ARE TO BE SOLID PANEL AND ENTIRLEY NON COMBUSTABLE. WHERE GLAZING IS TO BE USED IN THE DOORS FIRE RATED GLASS TO RADIANT HEAT.
- THE GARAGE DOOR IS TO BE SEALED TO PREVENT THE ENTRY OF EMBERS INTO THE STRUCTURE
- A SPRINKELR DRENCHING SYSTEM IS TO BE INSTALLED ON THE NORTH, AND SOUTH OF THE DWELLING WHICH IS TO BE POSITIONED ABOVE VENUERABLE WINDOWS AND DOORS TOGETHER WITH EQUIVALENT TO 20,000 LITRE NON COMBUSTABLE WATER SUPPLY TANK POWERED BY A DIESEL PUMP WHICH IS APPROPRIATE TO RUN THE SYSTEM FOR A MINIMUM OF 2 HOURS. A 38MM STORZ FITTING AND BALL OR GATE IS TO BE IN THE TANK(S)
- A STATIC WATER SUPPLY (SWS) MARKER IS TO BE OBTAINED FROM THE RFS AND BE CLEARLY LOCATED FOR ALL TO SEE.
- A 1.8 METER HIGH NON COMBUSTABLE RADIANT HEAT FENCE IS TO BE INSTALLED ON THE WEST ASPECT OF THE PROPOSED DWELLING. THE BOTTOM OF THE FENCE IS TO BE IN DIRECT CONTACT WITH THE GROUND
- THE ENTIRE PROPERTY SHALL BE MANAGED AS AN "INNER PROTECYION AREA" AS OUTLINED IN SECTION 4.1.3 AND APPENDIX 2 IN PLANNING FOR BUSHFIRE PROTECTION 2006
- UNRESTRICTED ACCESS IS TOBE AVAILABLE TO THE RFS AT ALL TIMES

DRAWN BY: JASON WALSMLEY

**JML Designs** ©

DRAWN

DATE 25/04/07

SCALE NTS

TITLE/DWG NO. PROPOSED BUSHFIRE PROTECTION PLAN FOR LOT 17 THE LINKS RD LEURA EURAMA VISION AUSTRALIA PTY LTD

**A2**